

**NOTES**

- ALL LEVELS ARE TO AUSTRALIAN HEIGHT DATUM (AHD).
- THE CONTRACTOR SHALL CONFIRM ALL LEVELS AND DIMENSIONS ON SITE PRIOR TO COMMENCING CONSTRUCTION OR ORDERING MATERIALS.
- THE CONTRACTOR SHALL CONFIRM THE LOCATION OF ALL EXISTING SERVICES PRIOR TO COMMENCEMENT OF CONSTRUCTION. THE CONTRACTOR SHALL MAKE ARRANGEMENTS WITH THE RELEVANT AUTHORITIES TO RELOCATE SERVICES AS NECESSARY TO RESOLVE CLASHES IN CONSULTATION WITH THE SUPERINTENDENT. ANY REPAIRS TO DAMAGED SERVICES WILL BE COMPLETED AT THE CONTRACTORS COST.
- DO NOT STRIP TOPSOIL OR SURFACE MATERIALS EXCEPT FROM AREAS SPECIFICALLY REQUIRED TO BE WORKED IN CONSTRUCTING THE WORKS DEFINED BY THESE DRAWINGS OR THE CONTRACT. NO TOPSOIL SHALL BE REMOVED FROM SITE.
- THE CONTRACTOR SHALL REINSTATE AND RE-VEGETATE ALL SURFACES THAT ARE STRIPPED INCLUDING THOSE FOR WHICH STRIPPING IS NOT SPECIFICALLY REQUIRED. REINSTATEMENT AND RE-VEGETATION SHALL BE UNDERTAKEN IN ACCORDANCE WITH THE TECHNICAL SPECIFICATION REQUIREMENT FOR UNPAVED AREAS.
- THE EXISTING SURVEY SHOWN IS FOR INFORMATION ONLY. THE CONTRACTOR SHALL VISIT THE SITE AND IDENTIFY ANY CHANGES DUE TO DEMOLITION OR PREVIOUS STAGE WORKS.
- MATCH NEW CONSTRUCTION NEATLY TO EXISTING ROADS.
- ALL EXISTING SERVICE PIT COVERS SHALL BE ADJUSTED TO NEW SURFACE LEVELS WHERE REQUIRED INCLUDING TELSTRA, WATER & SEWER ETC).
- THE CONTRACTOR SHALL PROVIDE A TRAFFIC MANAGEMENT PLAN TO COUNCIL AND OBTAIN APPROVAL PRIOR TO COMMENCING WORKS.
- ALL ALLOTMENT FILL SHALL BE UNDERTAKEN WITH LEVEL 1 SUPERVISION AND CERTIFICATION THAT IDENTIFIES ALL ALLOTMENTS ON WHICH THE FILL IS PLACED.
- SOIL EROSION DRAINAGE MANAGEMENT PLAN (SEDM) SHALL BE APPROVED BY THE SUPERINTENDENT, THE EPA AND COUNCIL. REFER SPECIAL CONDITIONS OF CONTRACT FOR REQUIREMENTS OF THE SEM. THE MEASURES RECORDED IN THE SEMD SHALL BE IN PLACE PRIOR TO EARTHWORKS COMMENCING ON SITE AND MONITORED AND REMAIN IN PLACE UNTIL THE SITE IS REVEGETATED.
- MAJOR AND SIGNIFICANT EARTHWORKS SHALL NOT BE UNDERTAKEN WHEN SOILS AT THE WORK SITE ARE SATURATED OR HEAVY RAIN IS IMMINENT IN THE AREA.
- PROVIDE TEMPORARY TURNAROUND AREAS AND STORMWATER CHANNELS AT STAGE BOUNDARY AS REQUIRED. TURNAROUND AREAS TO BE 18m DIAMETER WITH 150mm QUARRY RUBBLE SURFACE.
- STREET SIGNS (CONTAINING COUNCIL'S LOGO) SHALL BE INSTALLED IN SLEEVES CONCRETED INTO THE GROUND IN ACCORDANCE WITH COUNCIL'S REQUIREMENTS.
- TREE PROTECTION ZONES SHALL BE ESTABLISHED AROUND ALL SIGNIFICANT TREES WITHIN THE WORKS AREA PRIOR TO ANY EARTHWORKS COMMENCING. NO PERSONS, VEHICLES OR MACHINERY SHALL ENTER THE TREE PROTECTION ZONES WITHOUT THE CONSENT OF THE SUPERINTENDENT AND COUNCIL. REFER SPECIAL CONDITIONS OF CONTRACT FOR DETAILS. ALL EXCAVATION WORK WITHIN TREE PROTECTION ZONES TO BE NON-DESTRUCTIVE (SUCH AS HYDRO-VAC OR APPROVED EQUIVALENT).
- WHERE FOOTPATH IS AGAINST KERB, USE SPECIAL KERB OUTLET DETAIL ARRANGEMENT ON DRAWING 16-1491-021
- IRRIGATION CONDUITS UNDER ROADS SHALL BE 100 DIAMETER PVC CLASS SNU PROVIDED WITH DRAW WIRES AND ENDCAPS. CONDUITS SHALL HAVE 0.75m MINIMUM COVER AND TERMINATE 0.5m MINIMUM BEHIND KERBS WITH FLAGGING TAPE AT ENDS OF CONDUITS BROUGHT TO THE SURFACE.

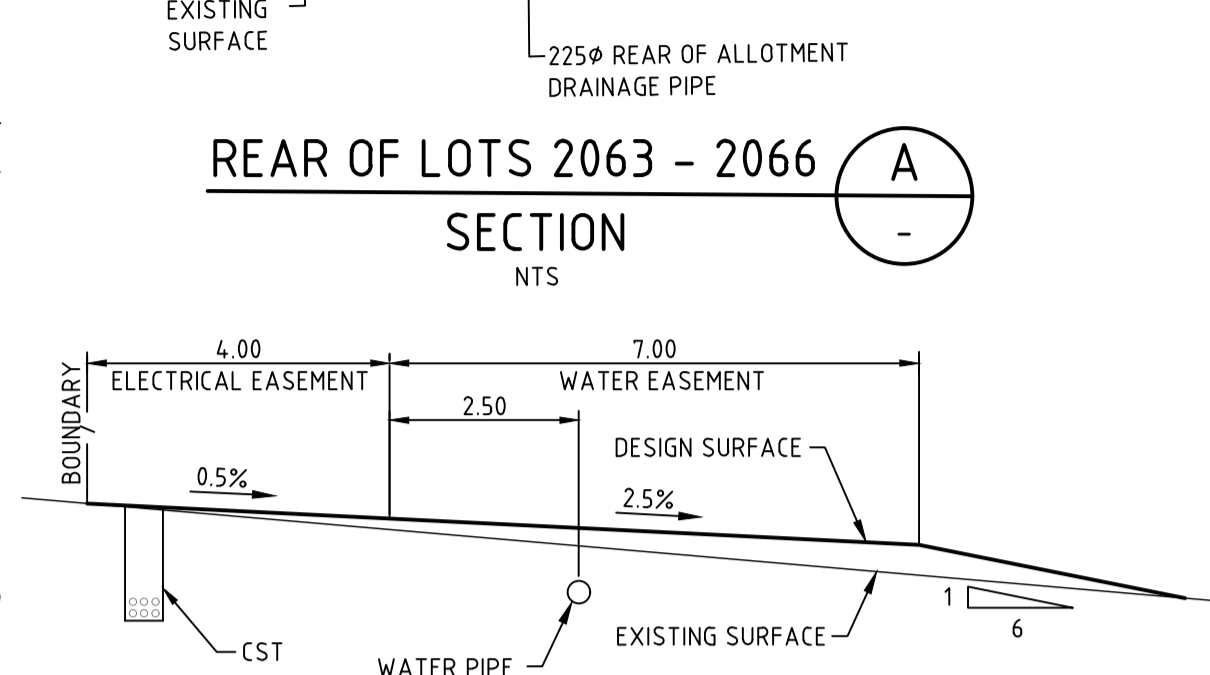
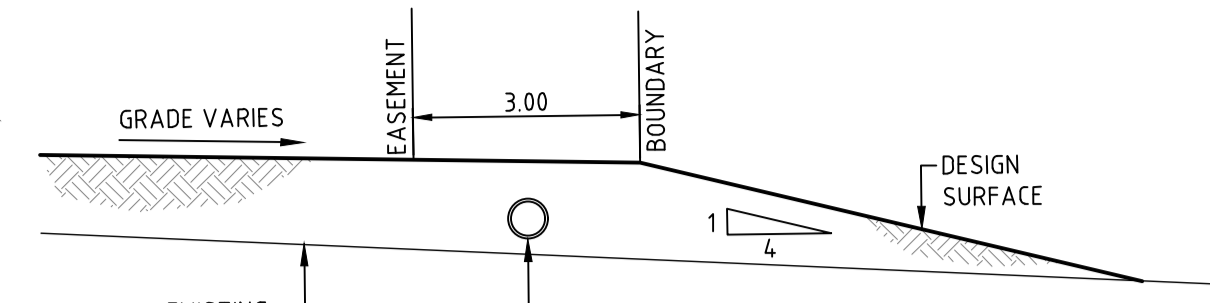

**LEGEND**

PROPOSED	DESCRIPTION	EXISTING	DESCRIPTION
	LIMIT OF WORKS BOUNDARY		REAR OF ALLOTMENT DRAINAGE CONNECTION
	DESIGN SURFACE LEVEL		FRONT OF ALLOTMENT UNDERGROUND DRAINAGE CONNECTION
	EXISTING SURFACE LEVEL		STORMWATER KERB INSERT
	STORMWATER PIT NUMBER		STREET SIGN
	ROAD CENTRELINE AND CHAINAGE		HAZARD BOARD
	100 HIGH MOUNTABLE KERB AND GUTTER		DRIVEWAY LOCATION
	150 HIGH BARRIER KERB AND GUTTER		ELECTRICAL TRANSFORMER
	150 HIGH BARRIER KERB AND TRAY		TREE PIT
	150 HIGH BARRIER KERB ONLY		SWALE REFER SHEET 020 FOR DETAIL
	100 HIGH MOUNTABLE KERB ONLY		EXTENT OF BATTER
	100 HIGH MOUNTABLE KERB AND TRAY		IRRIGATION CONDUIT
	600 WIDE SPOON DRAIN		IRRIGATION CONDUIT UNDER FOOTPATH
	200 WIDE FLUSH KERB		TOP OF RETAINING WALL LEVEL BOTTOM OF RETAINING WALL LEVEL RETAINING WALL HEIGHT
	EDGE STRIP		ZERO LOT LINE
	KERB TRANSITION OVER 1m		EXISTING SURFACE CONTOUR
	1.2m WIDE KERB RAMP		TREE
	RETAINING WALL		STORMWATER DRAIN
	EARTHWORKS BATTER		EXPOSED AGGREGATE CONCRETE FOOTPATH
	EXPOSED AGGREGATE CONCRETE FOOTPATH		JUNCTION BOX
	ASPHALT PAVEMENT		LIGHT POLE
	INTERLOCKING BLOCK ROAD PAVEMENT		STORMWATER DRAIN
	CONCRETE PAVEMENT		EXISTING PUMPING MAIN
	ALLOTMENT FILL		EXISTING WATER MAIN
	STORMWATER DRAIN		EXISTING TELSTRA MAIN
	SIDE ENTRY PIT		
	JUNCTION BOX		
	GRATED INLET PIT		

**FOR CONSTRUCTION**

REVISION	DATE	DESCRIPTION	DESIGN	DRAWN	APPROVED
0	05.02.17	ISSUED FOR CONSTRUCTION	KDA	KDA	AF
F	29.01.18	ISSUED FOR APPROVAL	KDA	KDA	
E	15.01.18	ISSUED FOR APPROVAL	NBM	NBM	
D	08.11.17	ISSUED FOR TENDER	NBM	KDA	
C	29.09.17	RE-ISSUED FOR APPROVAL	NBM	NBM	
B	03.07.17	ISSUED FOR APPROVAL	NBM	NBM	
A	30.03.17	FIRST CUT	NBM	NBM	

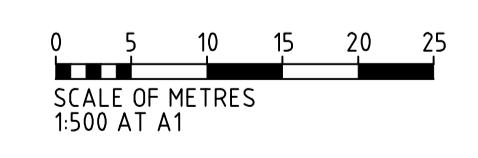

DESIGN	NBM	DESIGN CHECK	BJC
DRAWN	NBM	DRAFTING CHECK	BJC
APPROVED		DATE	
CAD FILE: 16-1491-002			
<b>A1</b>			
THIS DRAWING REMAINS THE PROPERTY OF GREENHILL ENGINEERS PTY LTD AND MAY NOT BE COPIED IN ANY WAY WITHOUT PRIOR APPROVAL FROM THIS COMPANY. © GREENHILL ENGINEERS PTY LTD			

**GREENHILL**

Level 1, 64 Hindmarsh Square  
Adelaide SA 5000  
T: 08 8406 1300  
F: 08 8215 0018

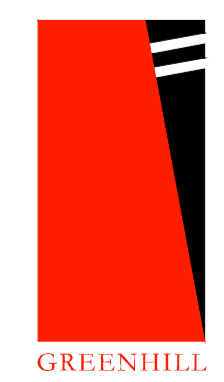

LANSER COMMUNITIES  
BLEFARI STAGE 2  
MOUNT BARKER

**GENERAL CONSTRUCTION AND  
STORMWATER DRAINAGE PLAN**

DRAWING NUMBER  
**16-1491-002**

REVISION  
**0**