

SHORT LINE SEGMENT TABLE

LINE	AZIMUTH	DISTANCE
L1	180°44'40"	3.5
L2	00°44'40"	3.5
L3	183°09'31"	0.628
L4	187°59'14"	2.905
L5	270°44'40"	3.237
L6	90°44'40"	3.207
L7	270°51'25"	3.7
L8	90°44'40"	3.175
L9	270°51'25"	3.345
L10	270°44'40"	2.4
L11	45°44'39"	2.97
L12	135°46'21"	2.968
L13	03°59'23"	3.505
L14	90°44'40"	3.175
L15	270°51'25"	2.3
L16	11°09'31"	2.413
L17	191°09'31"	0.323
L18	270°51'25"	2.378

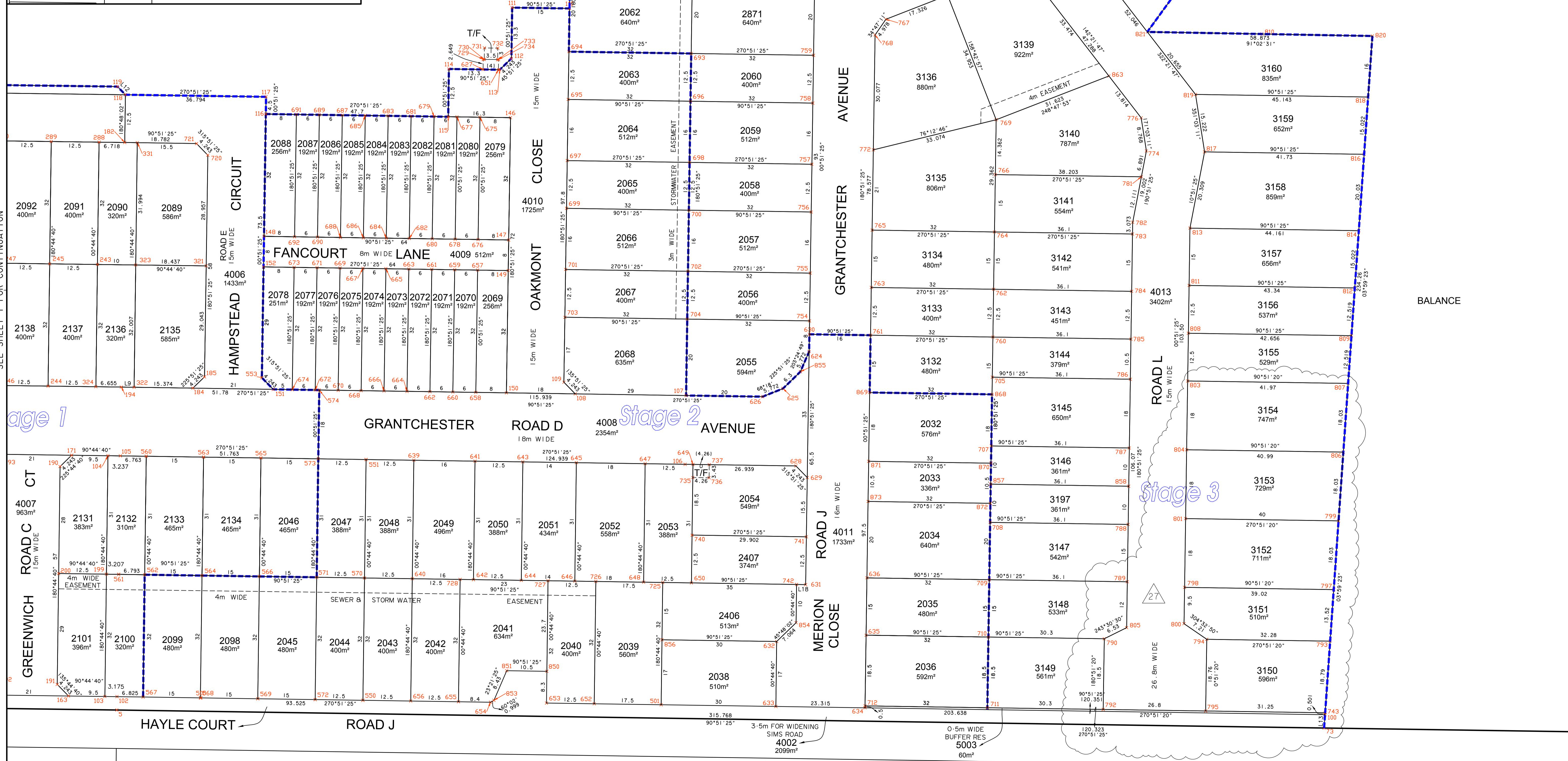
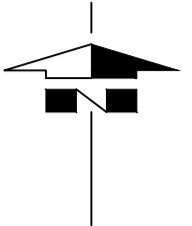

SEE SHEET 1 FOR CONTINUATION

Stage 1

Stage 2

Stage 3



PLAN DETAILS

COUNCIL :	DC OF MOUNT BARKER
MAP SHEET :	6627-06.07
CT REFS :	CT 5491/858 CT 6048/630

LEVEL DATUM :	N/A	DATA FILE/S :	21003C00_Blefari.crd
LEVEL AUTHORITY :	N/A	SURVEYOR :	
CO-ORD DATUM :	MGA94 PLANE SYSTEM BASED ON PSM 6627/14226 09/04/2009		

NO.	REVISION	STAFF	CHECK	DATE
27	AMEND ALLOTS 3148-3154; REMOVE RES 5004	JJB	FYF	5/12/18
26	ALLOTS 3163-3165 REMOVED FROM STAGE 3	JJB	FYF	7/11/18
25	AMEND LOTS 3160, 3164 & 3165	AGM	JJB	17/09/18
24	AMEND STAGE 3 ROAD AND LOT LAYOUT	AGM	AGM	12/06/18
23	AMEND ROAD L AND RESERVE 5004	AGM	JJB	27/03/18

LANSER DEVELOPMENTS		INSTRUCTION :	21003/21/1
CALCULATION PLAN - Blefari STAGE 2 & 3		DATE	05/12/2018
SECTION 4457 & LOT 105 in D82343		SHEET	2 OF 2
HUNDRED OF MACCLESFIELD		REV.	
MOUNT BARKER		DRAWING	21003C07-27

ORIGINAL SIZE A1