

5<sup>th</sup> January 2023

Reference No. SMS1.22118-L47.Rev0

Mr. David Rowe  
AR Contracting Services  
649 Port Road  
WOODVILLE PARK SA 5011

**LOT 669 STONELEIGH AVENUE – ASTON HILLS STAGE 9, MOUNT BARKER**

Dear David,

SMS Geotechnical Pty Ltd (SMS) was commissioned by AR Contracting Services to provide Level 1 earthworks inspection and testing services during fill placement on Lot 669 Stoneleigh Avenue, Mount Barker. The area where fill was placed is shown approximately in Drawing SMS1.22118-F47.Rev0.

SMS were provided with a TBM by AR Contracting Services which was used to measure and record both pre and post fill levels. Post fill levels were taken prior to the placement of topsoil. The post fill levels were measured at approximately the same locations as the pre fill levels. These levels are detailed in Drawing SMS1.22118-F47.Rev0.

Whilst the utmost amount of care was taken while measuring these levels, SMS is not a licensed surveyor and the difference in measurements on Drawing SMS1.22118-F47.Rev0 may differ slightly to the maximum depth of placed fill on this site.

Level 1 inspection and testing services were carried out by SMS to Australian Standard AS3798-2007 "Guidelines on earthworks for commercial and residential developments" between 22<sup>nd</sup> February 2022 and 27<sup>th</sup> September 2022. The subgrade was inspected and showed no signs of organic or unsuitable material. Subgrade proof rolling was witnessed prior to fill being placed and was deemed suitable by SMS' representative on site.

SMS conducted in situ density testing to AS1289.5.8.1 at randomly selected locations throughout areas in which fill was placed as per frequencies outlined in AS3798-2007. The density test results have been issued separately to AR Contracting Services and are retained in our project file. The required laboratory dry density ratio was achieved on all tests taken during fill placement. Laboratory tests were conducted to AS1289.5.1.1.

On the completion of Level 1 earthworks inspection and testing, SMS advise that the fill placed on Lot 669 Stoneleigh Avenue as shown in Drawing SMS1.22118-F47.Rev0, was witnessed and in our opinion meets the requirements of "Controlled Fill" as defined in AS3798-2007 and AS2870-2011 "Residential slabs and footings".

However, it should be recognised that the passage of time affects the information provided in this letter. SMS's opinions are based upon information that existed at the time that our services were provided. The services allowed SMS to form no more than an opinion of the fill placement undertaken under our Level 1 inspection and testing services at the times the earthworks were carried out. These services cannot be used to assess the effect of any subsequent further works at the site.

If you have any questions relating to this project or require any additional information, please contact our office on (08) 8258 7498.

**SMS GEOTECHNICAL PTY LTD**



**Luke Garcia**  
Laboratory Manager

Attachments: Drawing SMS1.22118-F47.Rev0

Location	Pre Fill	Post Fill
Lot 669	361.100	363.400

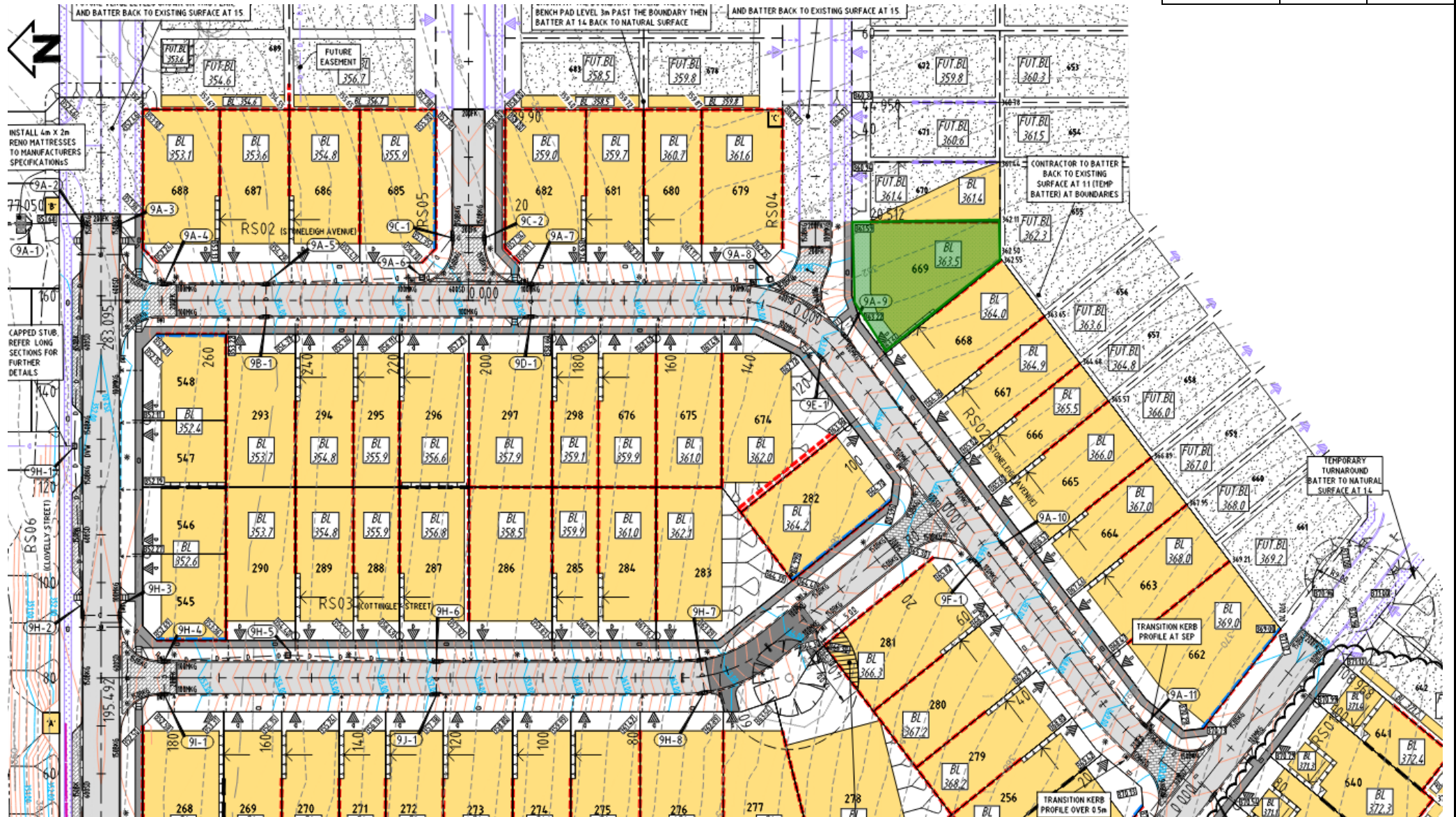

 Approx. Fill Location

**SMS**  
**GEOTECHNICAL**  
*Quality in Construction*

Drawn:	LG	Date:	04.01.2023
Checked:	DM	Date:	04.01.2023
Revision:		Date:	
Scale:	NTS		A4

**AR CONTRACTING SERVICES**  
**ASTON HILLS STAGE 9**  
**MOUNT BARKER**  
**SITE PLAN SHOWING PRE AND POST FILL LEVELS**

Project No.:	SMS1.22118	Drawing No.:	SMS1.22118-F47.Rev0
--------------	------------	--------------	---------------------